

### Model # 009

Cable Grip  
Connector



Electrical connection to a Granzow solenoid valve is via a DIN connector. The connector plugs onto the spades of the coil, and a profile gasket ensures a NEMA 4 water-tight connection.

Granzow offers three types of DIN connectors: cable grip connectors, 1/2" conduit connectors, and a 6-foot power cord connector. This model (009) is a Cable Grip Connector.

#### Connector Dimensions

Width (A):	7/8"
Height (B):	1-3/32"
Length (C):	1-1/4"
Height (D):	1-21/32"
Height (E):	1-3/32"
Width (G):	18mm
Height (H):	18mm

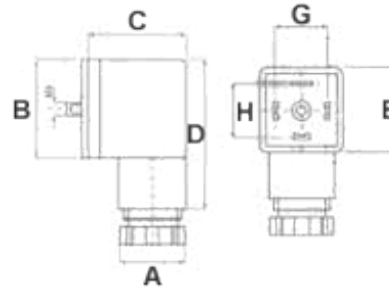

For more information about our solenoid valve DIN connectors, visit  
<http://www.granzow.com/valves/dinconnectors/>