

### Coil 12W

12-Watt Solenoid Valve Coil

#### PA

Molding Materials

#### DIN (NEMA 4)

Electrical Connection

#### DC +10% -5%

Nominal Voltage

#### AC +10% -15%

Tolerances



#### Coil Dimensions

Coil Width (A):	1 7/16"
Coil Length (B):	1 29/32"
Coil Length (C):	2 3/8"
Coil Height (D):	1 9/16"

#### Electrical Connection

Inrush VA:	36
Holding VA:	23
Electrical Connection:	DIN (NEMA 4)

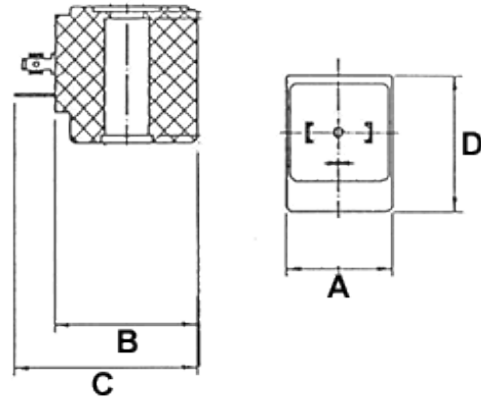

**Note:** Additional voltages are available upon request.

### COIL SPECIFICATIONS

**Nominal Voltage:** DC +10% -5%

**Tolerances:** AC +10% -15%

Code	Power (Watts)	Voltages	ED	Approvals
UDA1156	12	V 120/60Hz	100%	CE
UDA12DC	12	V 12 D.C.	100%	CE
UDA2305	12	V 230/50Hz	100%	CE
UDA2450	12	V 24/50Hz	100%	CE
UDA24DC	12	V 24 D.C.	100%	CE

### MOLDING MATERIALS

Mold	Material	Description	Class	Temperature
UDA	PA	Black polyamide	F	310°F

For more information about our solenoid valve coils, visit  
<http://www.granzow.com/valves/coils/>