

Coil 8W

8-Watt Solenoid Valve Coil

PA, PET, PPS

Molding Materials

DIN (NEMA 4)

Electrical Connection

DC +10% -5%

Nominal Voltage

AC +10% -15%

Tolerances



Coil Dimensions

Coil Width (A):	1 3/16"
Coil Length (B):	1 21/32"
Coil Length (C):	2 1/8"
Coil Height (D):	1 17/32"

Electrical Connection

Inrush VA:	25
Holding VA:	14.0
Electrical Connection:	DIN (NEMA 4)

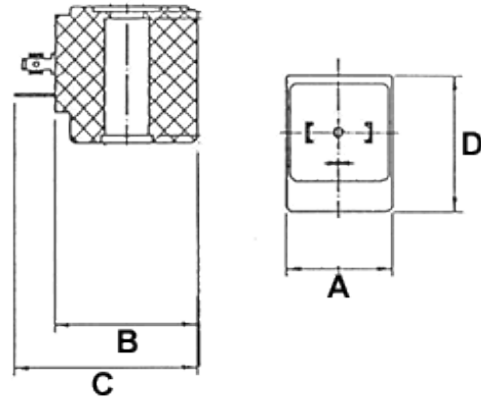

Note: Additional voltages are available upon request.

COIL SPECIFICATIONS

Nominal Voltage: DC +10% -5%

Tolerances: AC +10% -15%

Code	Power (Watts)	Voltages	ED	Approvals
ADF11B	8	V 115/60Hz	100%	CE, UL
ADF12DC	11	V 12 D.C.	100%	CE, UL, CSA
ADF22B	8	V 220/60Hz	100%	CE, UL
ADF24B	8	V 24/60Hz	100%	CE, UL
ADF24DC	11	V 24 D.C.	100%	CE, UL, CSA
BDU1156	8	V 110-120/50-60Hz	100%	CE, UL, CSA
BDU2356	8	V 220-240/50-60Hz	100%	CE, UL, CSA
BDU2460	8	V 24/60Hz	100%	CE, UL, CSA
DA12DC	8	V 12 D.C.	100%	CE
DA24DC	8	V 24 D.C.	100%	CE

MOLDING MATERIALS

Mold	Material	Description	Class	Temperature
ADF	PPS	Black polyphenylsulphide	H	360°F
BDU	PET	Black polyester	F	312°F
DA	PA	Black polyamide	F	310°F

For more information about our solenoid valve coils, visit
<http://www.granzow.com/valves/coils/>