

Series PAMX-45

Compact Design, 316 Stainless Steel,
Air-Actuated Valve Series

1/2" - 3/4"
NPT Connection

1/2" - 3/4"
Orifice Size

0-230 psi
Operating Pressure



Technical Specifications

Media Temperature:	14-360°F
Ambient Temperature:	14-140°F
Body Material:	Stainless steel AISI 316L
Seal Material:	PTFE
Pilot Media:	Air, Inert Gases, Water
Optical Position Indicator:	Standard
Anti-Waterhammer:	With 2 → 1 Flow

Note: Actuator housing 360° rotation.

Additional Information

Flow Type:	NC, NO, or Double-Acting
Flow Direction:	(See models on next page)
Medium Examples:	Water, Oil, Air, Steam, Aggressive Media*

*Working pressure with steam is 150 psi maximum.

Pressure Chart of Series PAMX-45

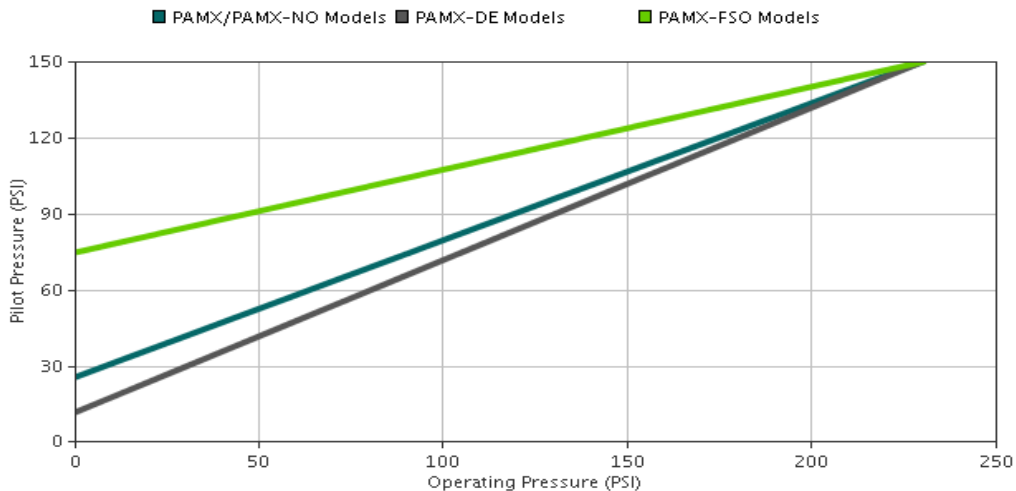

AVAILABLE VALVE MODELS

Model #	NPT	Orifice	Flow Rate (CV)	Operating Pressure (PSI)		Flow Direction	Pilot Pressure (PSI)		Actuator Diameter
				Min	Max		Min	Max	
PAMX 15-45	1/2"	1/2"	4.8	0	230	1 → 2	26	150	1 3/4"
PAMX 20-45	3/4"	3/4"	9.0	0	230	1 → 2	26	150	1 3/4"
PAMX 15-45 FSO	1/2"	1/2"	4.8	0	230/230	1 → 2/2 → 1	75	150	1 3/4"
PAMX 20-45 FSO	3/4"	3/4"	9.0	0	230/100	1 → 2/2 → 1	75	150	1 3/4"
PAMX 15-45 NO	1/2"	1/2"	4.8	0	230	2 → 1	26	150	1 3/4"
PAMX 20-45 NO	3/4"	3/4"	9.0	0	230	2 → 1	26	150	1 3/4"
PAMX 15-45 DE	1/2"	1/2"	4.8	0	230	1 ↔ 2	12	150	1 3/4"
PAMX 20-45 DE	3/4"	3/4"	9.0	0	230	1 ↔ 2	12	150	1 3/4"

VALVE MODEL DIMENSIONS

Model #	Width (A)	Width (B)	Height (C)	Height (D)	Width (E)	Weight
PAMX 15-45	2-9/16"	6-1/16"	5-11/32"	4-27/32"	2-1/4"	2.80 lbs.
PAMX 20-45	2-15/16"	6-3/32"	5-3/32"	5-1/8"	2-1/4"	3.00 lbs.
PAMX 15-45 FSO	2-9/16"	6-1/16"	5-11/32"	4-27/32"	2-1/4"	2.80 lbs.
PAMX 20-45 FSO	2-15/16"	6-3/32"	5-3/32"	5-1/8"	2-1/4"	3.00 lbs.
PAMX 15-45 NO	2-9/16"	6-1/16"	5-11/32"	4-27/32"	2-1/4"	2.80 lbs.
PAMX 20-45 NO	2-15/16"	6-3/32"	5-3/32"	5-1/8"	2-1/4"	3.00 lbs.
PAMX 15-45 DE	2-9/16"	6-1/16"	5-11/32"	4-27/32"	2-1/4"	2.80 lbs.
PAMX 20-45 DE	2-15/16"	6-3/32"	5-3/32"	5-1/8"	2-1/4"	3.00 lbs.

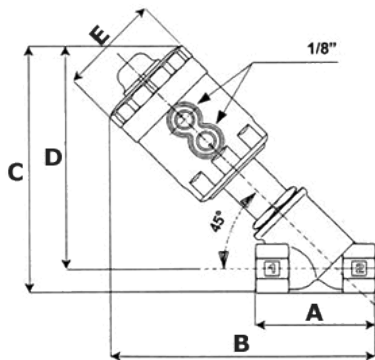

For more information,
visit our web site at
www.granzow.com